

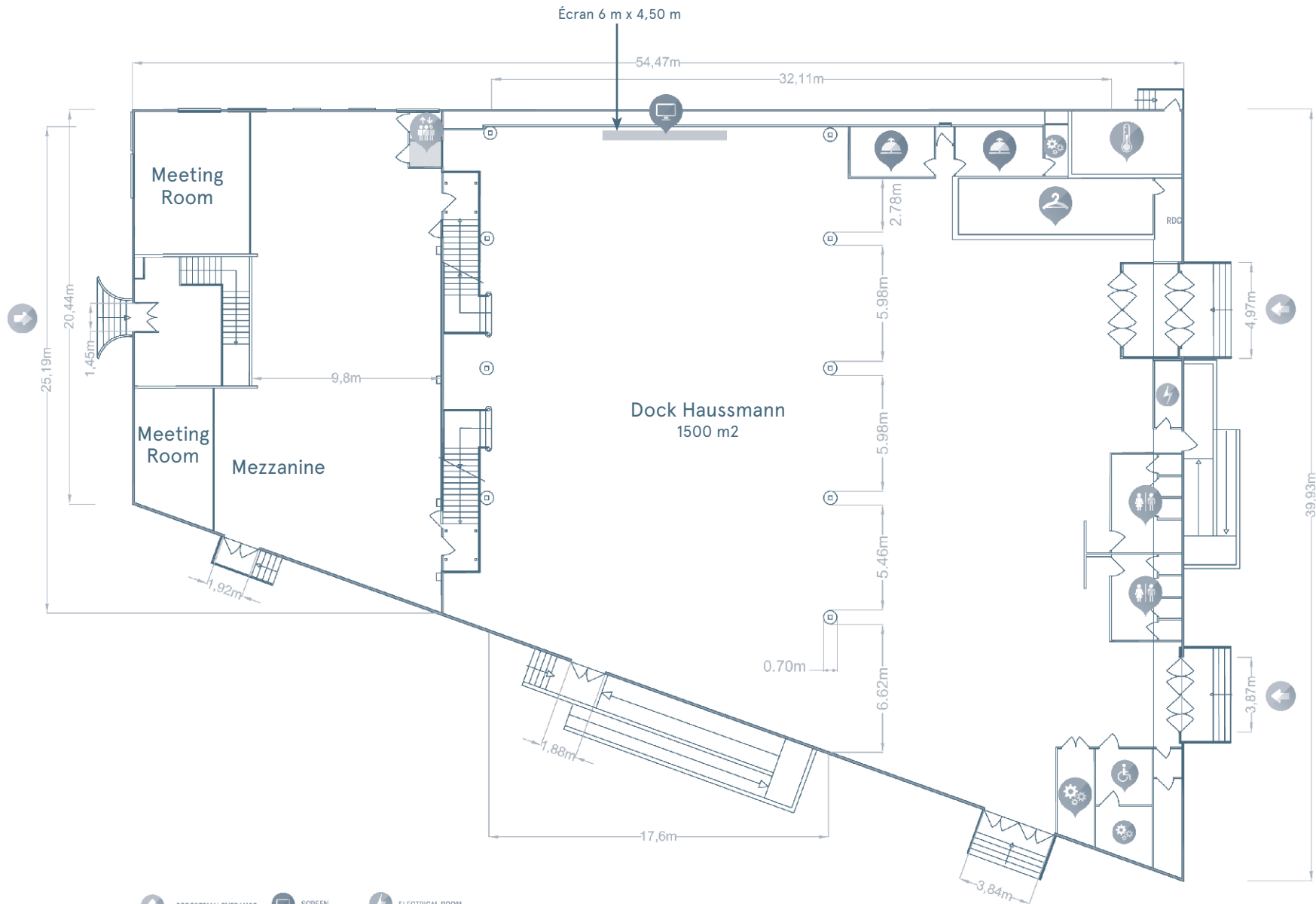

# Les Docks de Paris - Dock Haussmann

87 Avenue des Magasins Généraux - 93300 Aubervilliers



- |   |                     |   |               |   |                 |
|---|---------------------|---|---------------|---|-----------------|
|  | PEDESTRIAN ENTRANCE |  | SCREEN        |  | ELECTRICAL ROOM |
|  | TOILETS             |  | BOILER ROOM   |  | TECHNICAL ROOM  |
|  | PRM TOILETS         |  | DRESSING ROOM |   |                 |
|  | CLOAKROOM           |   |               |   |                 |

Heights :

- ▶ minimal : 4,70 m
- ▶ side : 7,20 m
- ▶ largest : 8,60 m







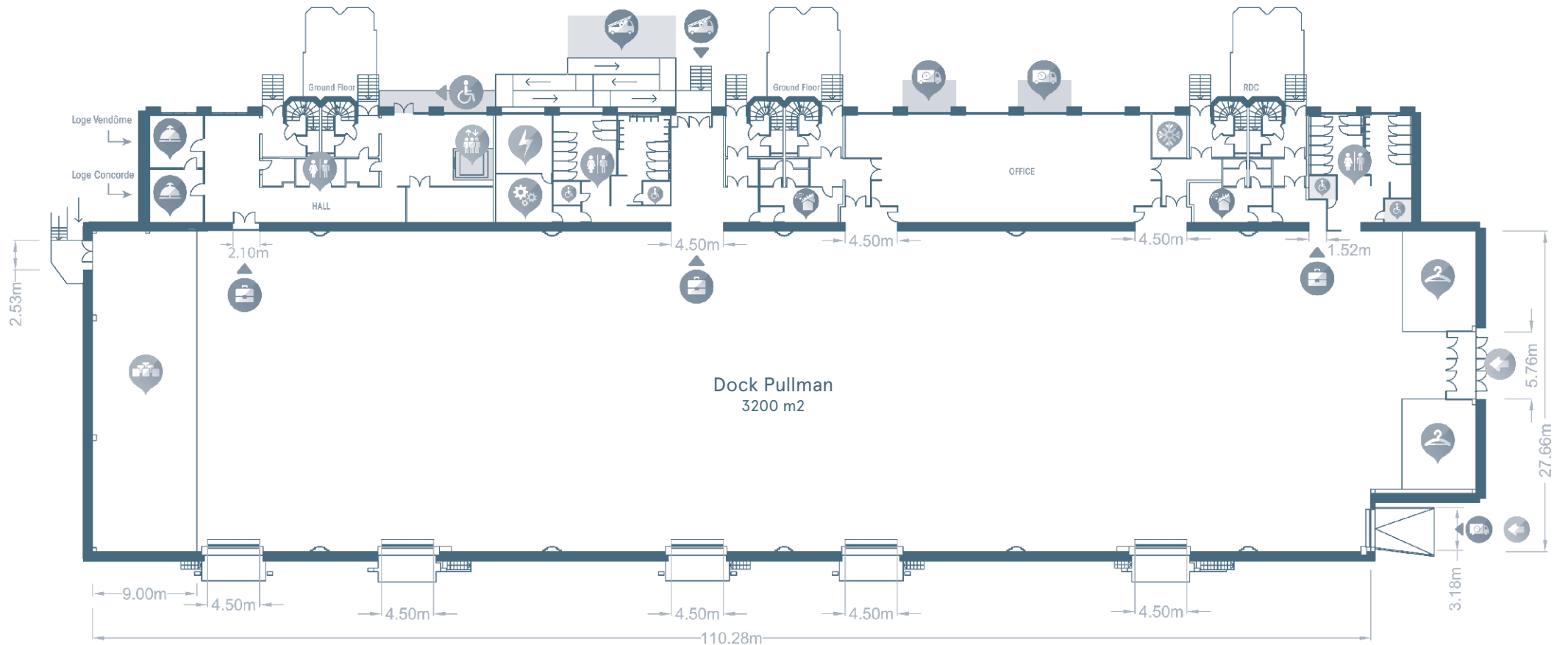









# Les Docks de Paris - Dock Pullmann

87 Avenue des Magasins Généraux - 93300 Aubervilliers



Dock Pullman  
3200 m<sup>2</sup>

-  PEDESTRIAN ENTRANCE
-  PRM ENTRANCE
-  STUDIO ENTRANCE
-  FIREMAN ENTRANCE & CAR PARK
-  DELIVERY PLATFORM AND ENTRANCE
-  TOILETS
-  PRM TOILETS
-  LIFT
-  CLOAKROOM
-  DRESSING ROOM
-  TECHNICAL ROOM
-  ELECTRICAL BOARD
-  FOLDING TIER (NON-USABLE SHADE)
-  COLD ROOM
-  FIRE SECURITY SYSTEM ROOM



▶ Railing Height : 9.40 m

# Les Docks de Paris - Dock Eiffel

87 Avenue des Magasins Généraux - 93300 Aubervilliers

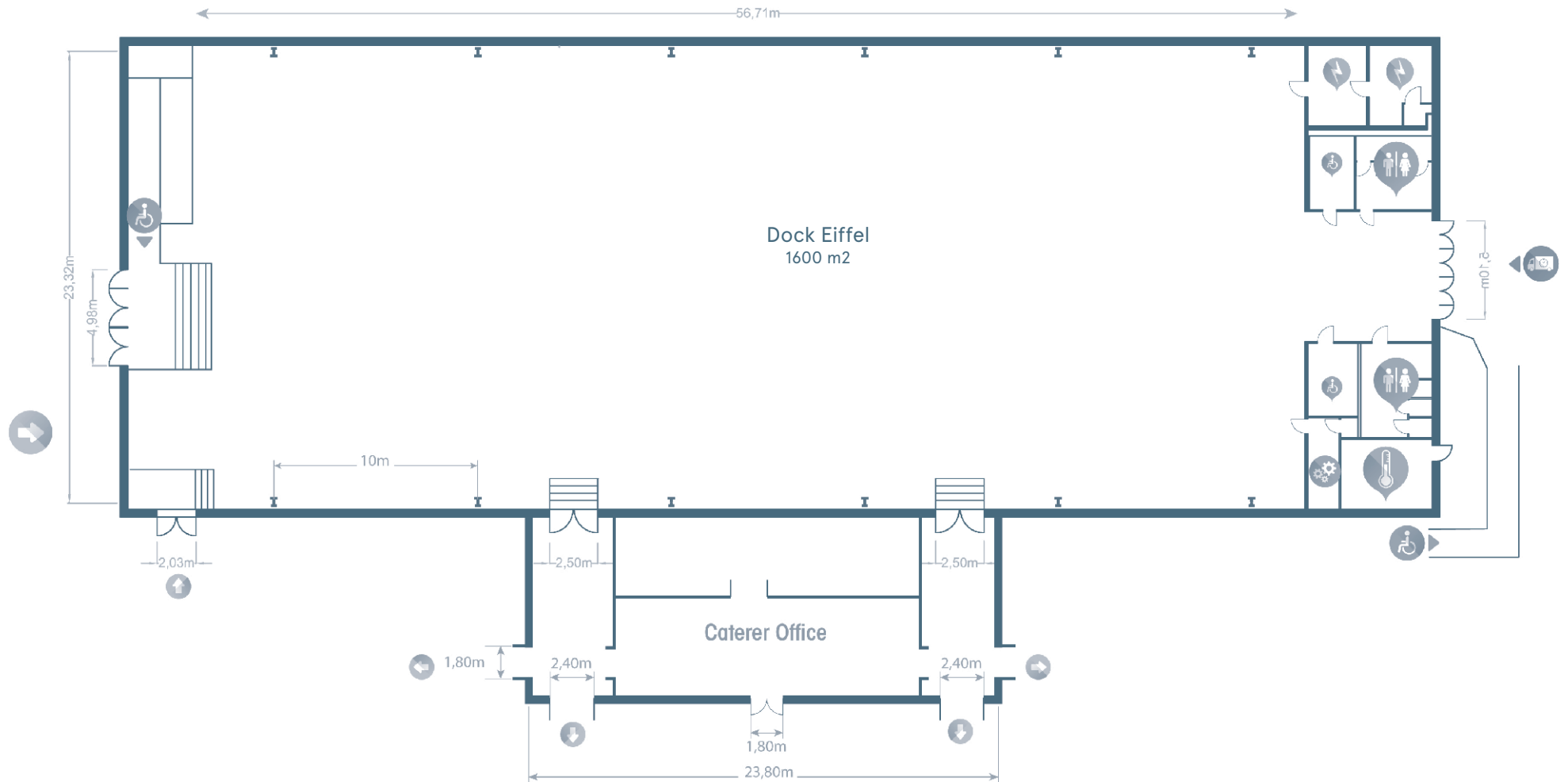

### Heights :

- ▶ minimal (under beam) : 4,60 m
- ▶ maximal (under beam) : 11,20 m

- |   |  |
|---|--|
|  PEDESTRIAN ENTRANCE |  PRM TOILETS      |
|  PRM ENTRANCE        |  BOILER ROOM      |
|  DELIVERY ENTRANCE   |  ELECTRICAL BOARD |
|  TOILETS             |  TECHNICAL ROOM   |

# Your meeting rooms

Formasquare Les Docks de Paris

## First Floor

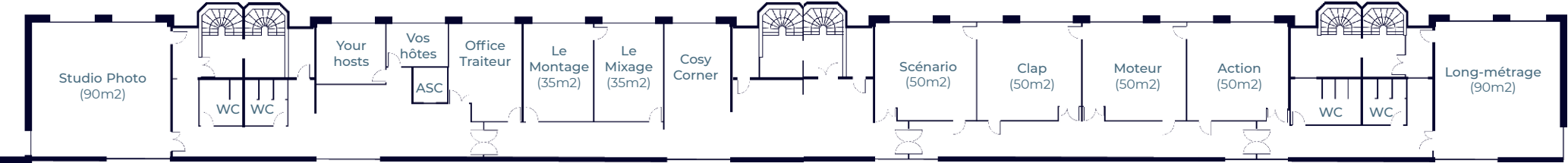

# Your meeting rooms

Formasquare Les Docks de Paris

## Second Floor

