

Your meeting rooms

Room layouts adapted to your specific meeting requirements

On the first floor of paved courtyard

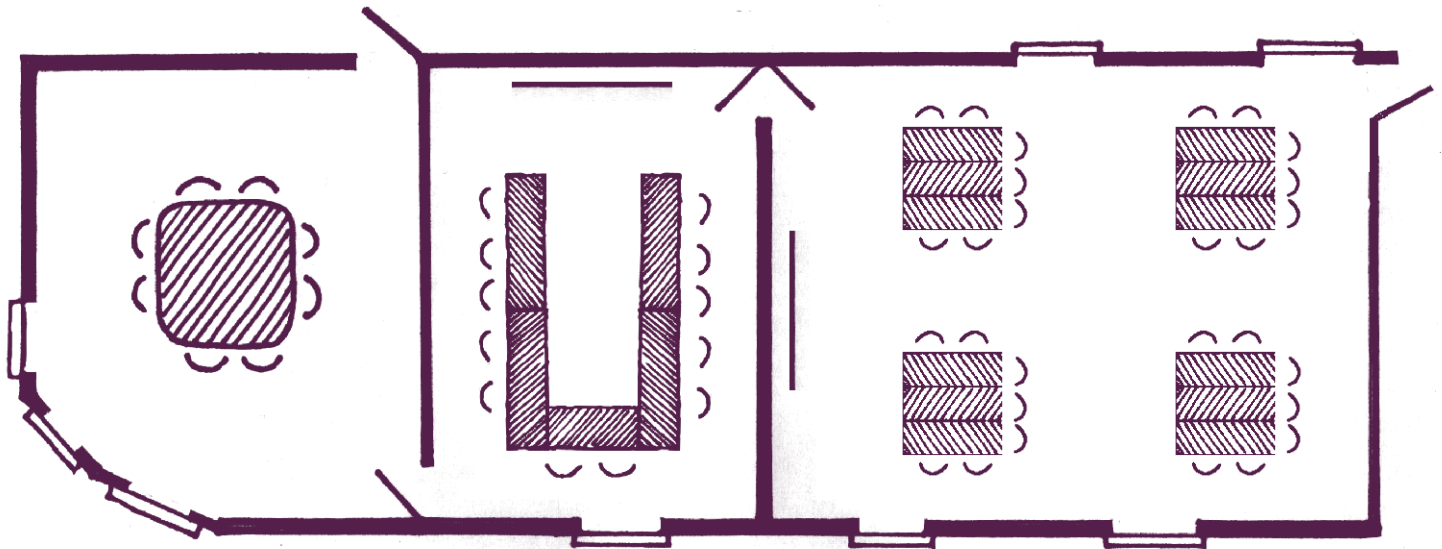

Azalée
(25 m², 5 m x 5 m)

Taxus
12 participants
(30 m², 6 m x 5 m)

Rosiers
28 participants
(54 m², 9 m x 6 m)

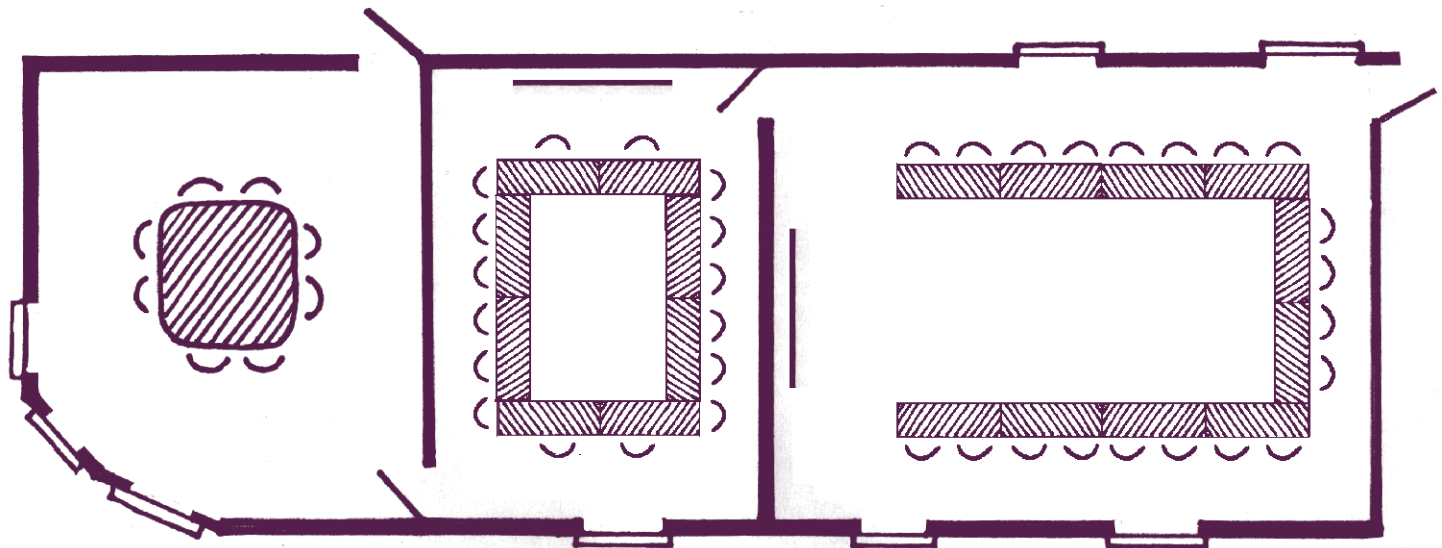

Azalée
(25 m², 5 m x 5 m)

Taxus
16 participants
(30 m², 6 m x 5 m)

Rosiers
20 participants
(54 m², 9 m x 6 m)



The home of seminars
Châteauform'

Château de Neuville-Bosc

Your meeting rooms

Room layouts adapted to your specific meeting requirements

Near the porch... the courtyard of Troène

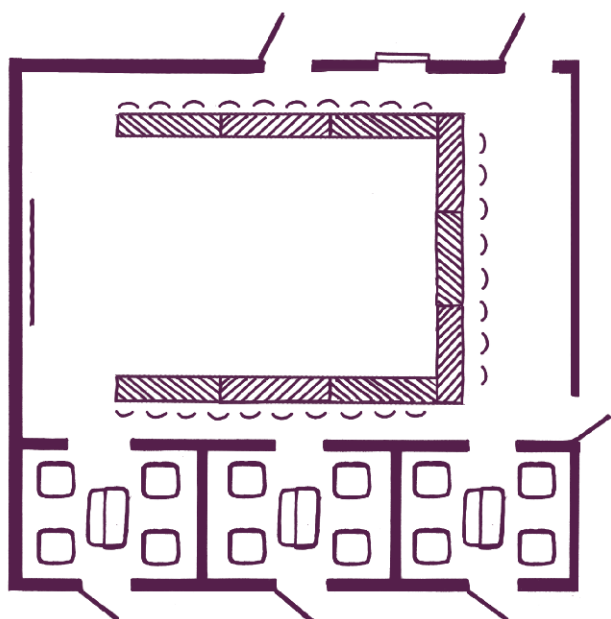

Houx

Buis

Vigne

28 participants

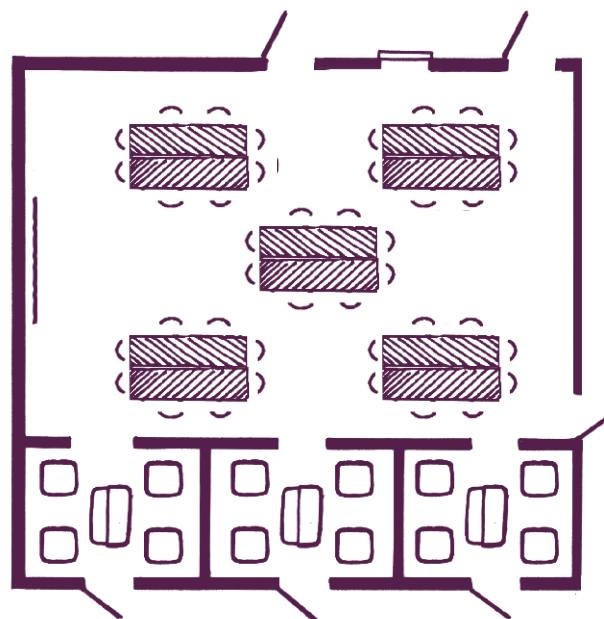

Houx

Buis

Vigne

40 participants

Troène and sub-committee rooms

(77 m², 11 m x 7 m)

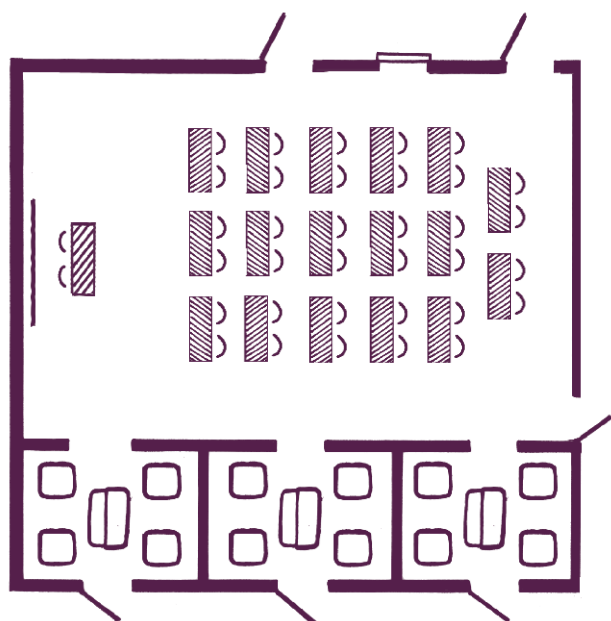

Houx

Buis

Vigne

35 participants

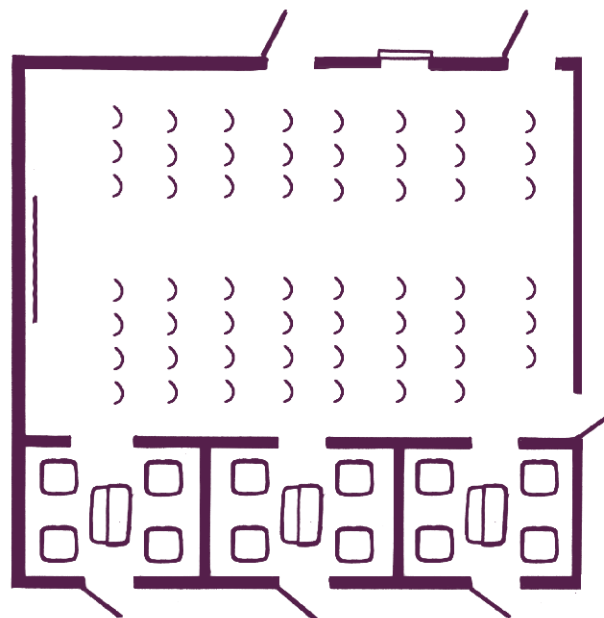

Houx

Buis

Vigne

55 participants

Troène and sub-committee rooms

(77 m², 11 m x 7 m)



The home of seminars
Châteauform'

Château de Neuville-Bosc

Your meeting rooms

Room layouts adapted to your specific meeting requirements

In the "Jardins" courtyard

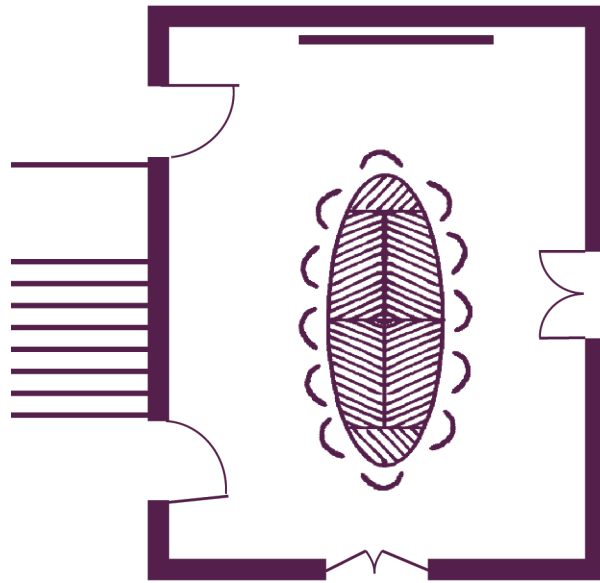

Glycine
12 participants
(30 m²)

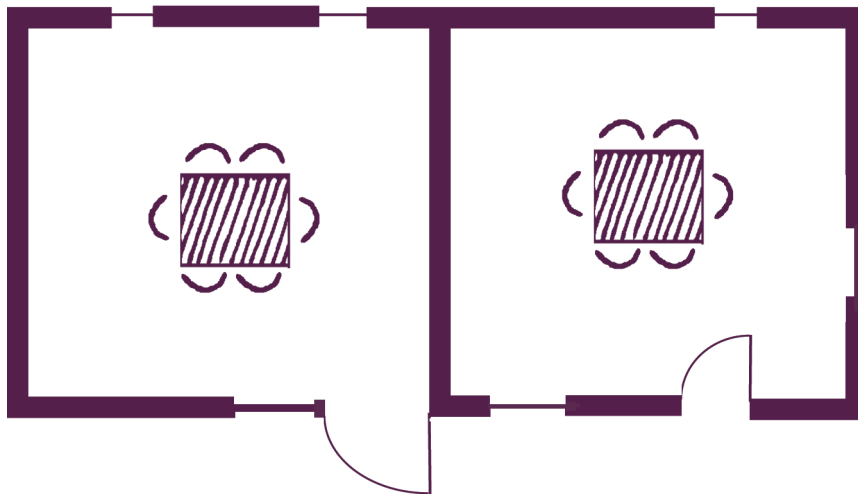

Bois joli
6 participants
(20 m²)

Bruyères
6 participants
(18 m²)

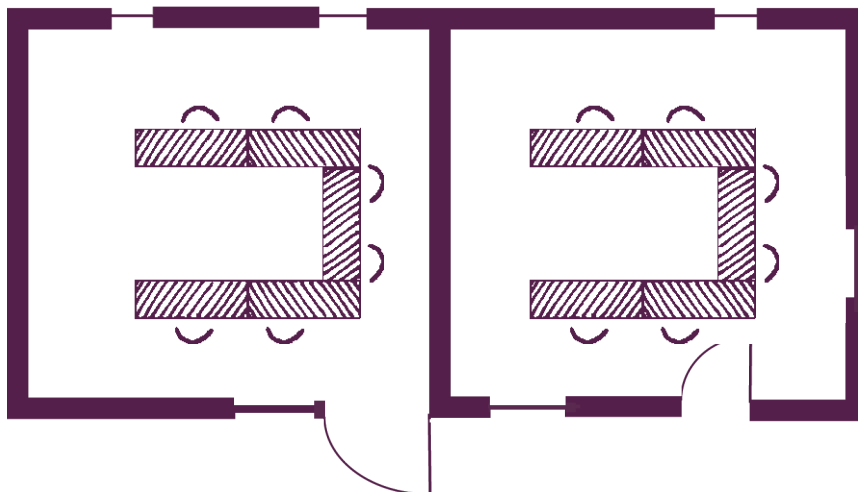

Bois joli
6 participants
(20 m²)

Bruyères
6 participants
(18 m²)



The home of seminars
Châteauform'

Château de Neuville-Bosc

Your meeting rooms

Room layouts adapted to your specific meeting requirements

In the “Jardins” courtyard

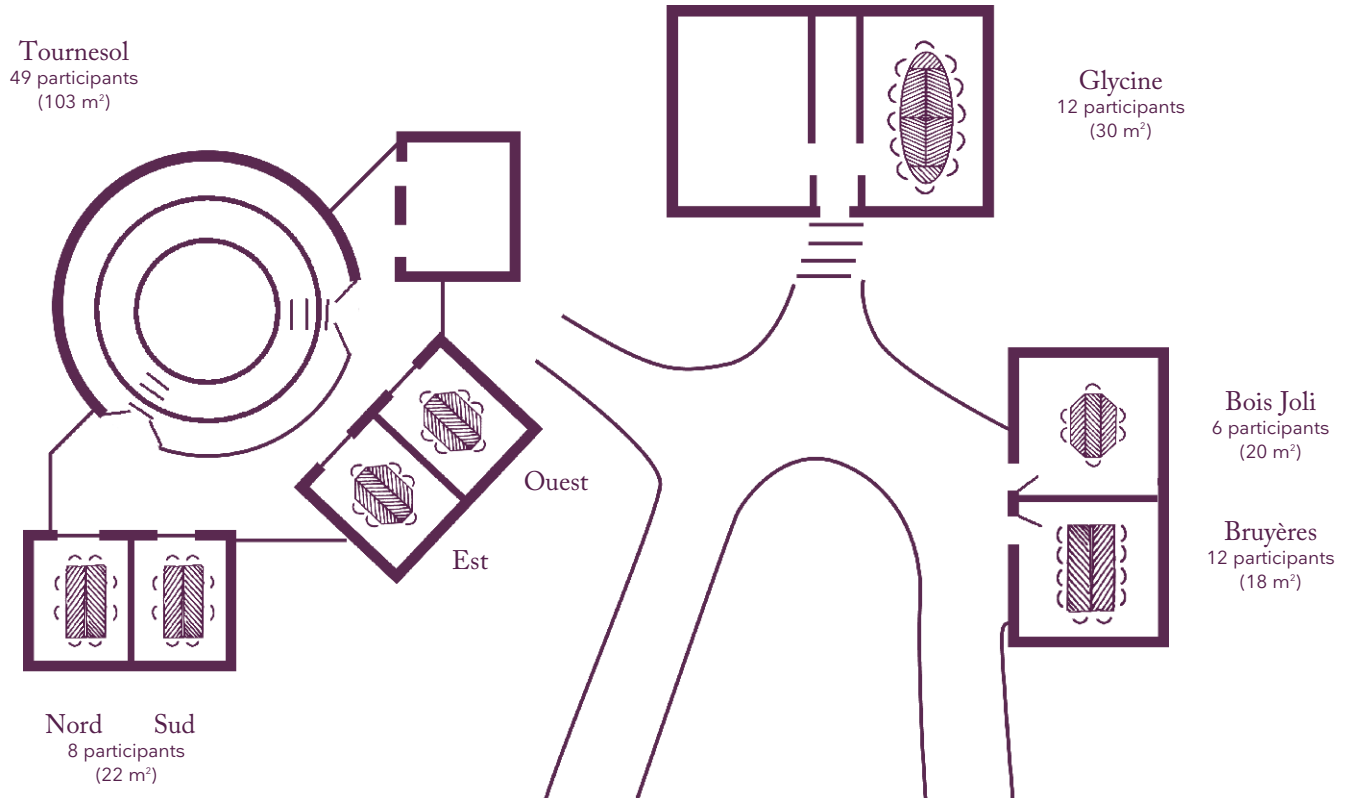

On the first floor of the château

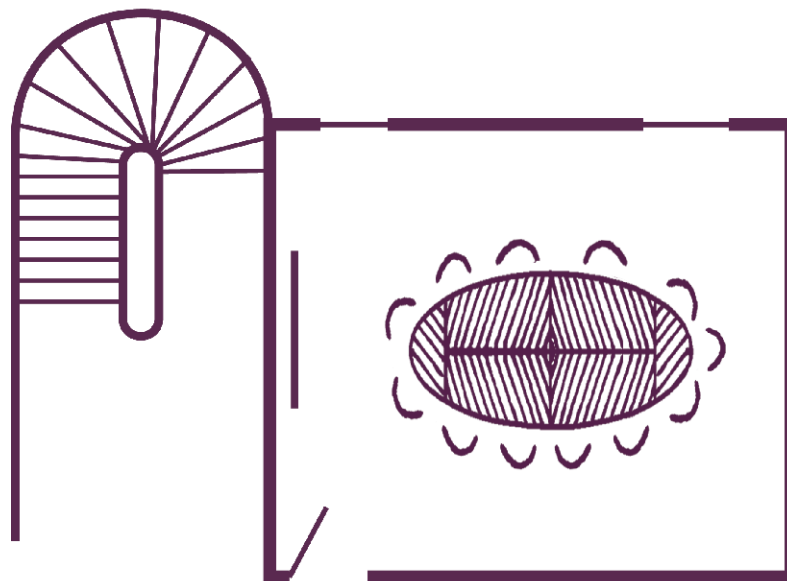

The home of seminars
Châteauform'

Château de Neuville-Bosc