

# Your meeting rooms

Room layouts adapted to your specific meeting requirements

## Ground floor

“Salle de sous-commission 2”

8 participants en “Conférence”  
(22 m<sup>2</sup>, 3,5 m x 6,5 m)

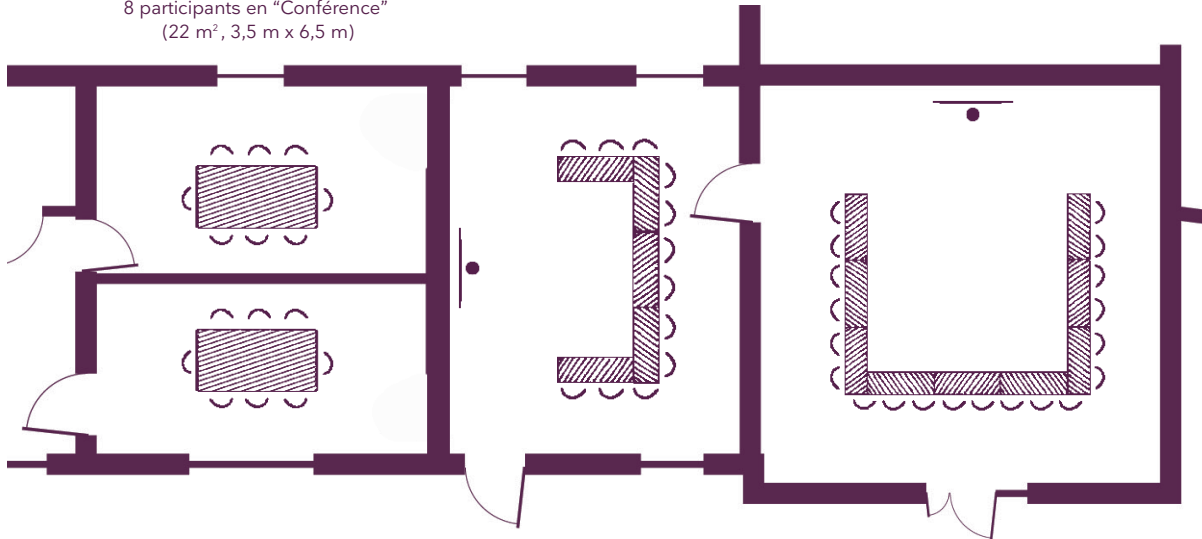

“Salle de sous-commission 1”

8 participants en “Conférence”  
(22 m<sup>2</sup>, 3,5 m x 6,5 m)

“Les contes de Perrault”

12 participants en “U”  
(38 m<sup>2</sup>, 5,5 m x 7 m)

“Les contes du chat perché”

20 participants en “U”  
(49 m<sup>2</sup>, 7 m x 7 m)

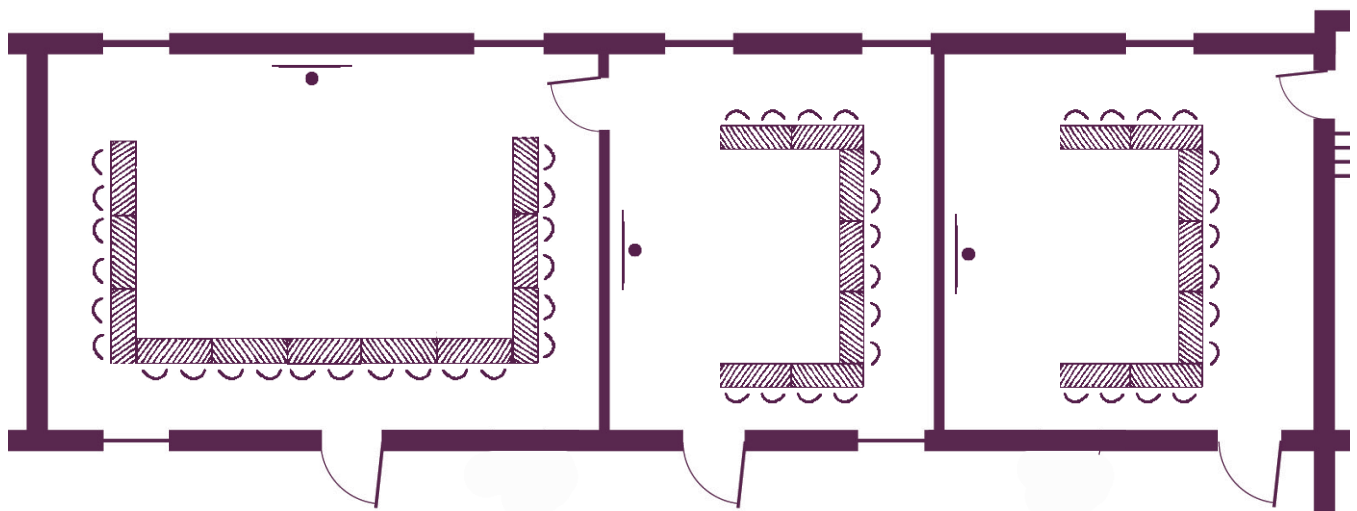

“Alphonse Daudet”

22 participants en “U”  
(70 m<sup>2</sup>, 6,5 m x 10,5 m)

“Les contes des milles et une nuit”

14 participants en “U”  
(45 m<sup>2</sup>, 6,5 m x 7 m)

“Lettres de mon moulin”

14 participants en “U”  
(49 m<sup>2</sup>, 7 m x 7 m)



# Your meeting rooms

Room layouts adapted to your specific meeting requirements

## Ground floor

### “Salle de sous-commission 4”

8 participants en “Conférence”  
(22 m<sup>2</sup>, 3,5 m x 6,5 m)

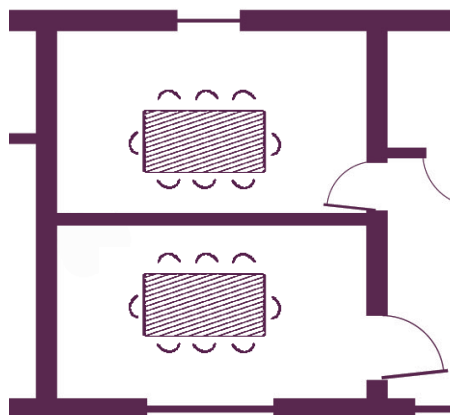

### “Salle de sous-commission 3”

8 participants en “Conférence”  
(22 m<sup>2</sup>, 3,5 m x 6,5 m)

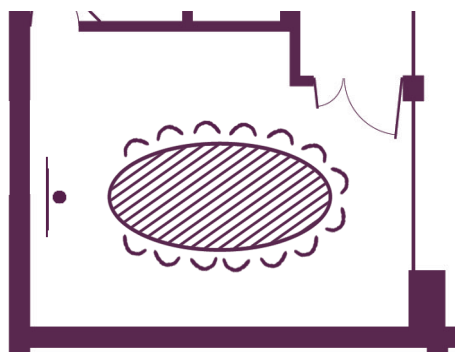

### “Il était une fois...”

15 participants en “Conférence”  
(30 m<sup>2</sup>, 4,5 m x 6,5 m)



# Your meeting rooms

Room layouts adapted to your specific meeting requirements

## Ground floor

“Salle de sous-commission 6”  
8 participants en “Conférence”  
(20 m<sup>2</sup>, 3,5 m x 5,5 m)

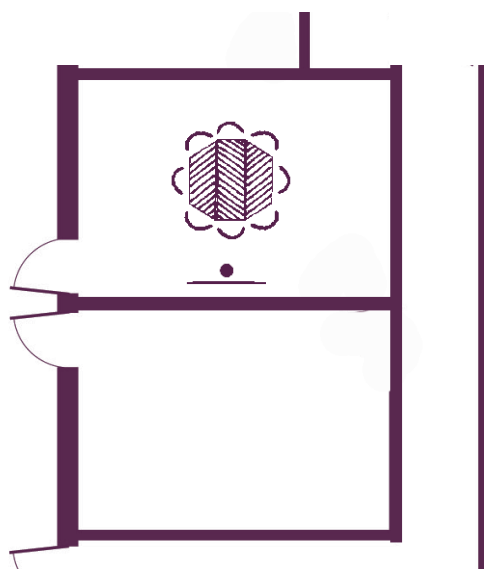

# Your meeting rooms

Room layouts adapted to your specific meeting requirements

Ground floor

“Les fables de la Fontaine”

67 participants en “Amphi”  
(140 m<sup>2</sup>, 10 m x 14 m)

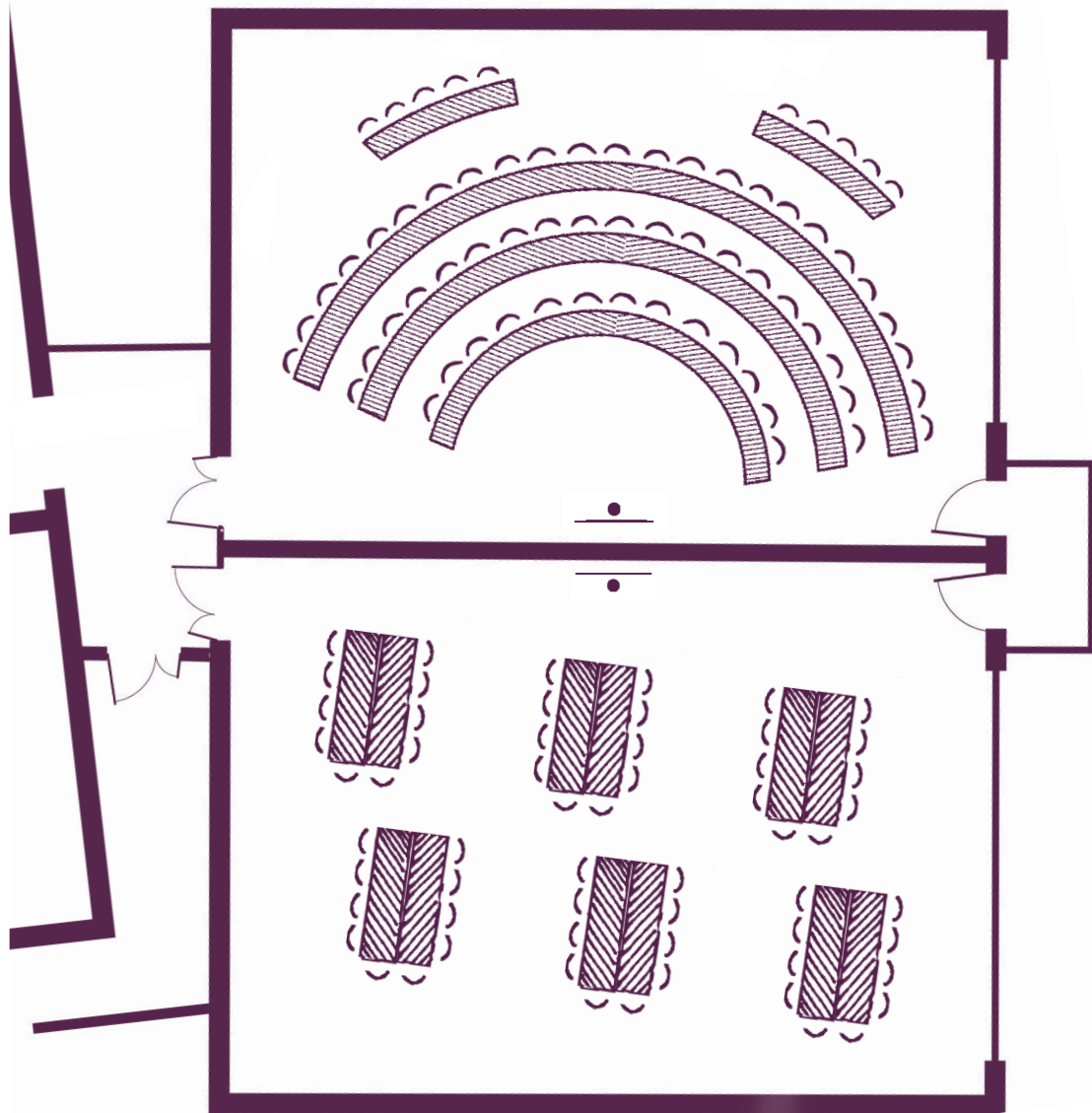

“Les contes de Grimm”

60 participants en “îlots”  
(140 m<sup>2</sup>, 10 m x 14 m)



The home of seminars  
Châteauform'

La maison des contes