

Vos salles de réunion

La disposition en fonction de vos objectifs

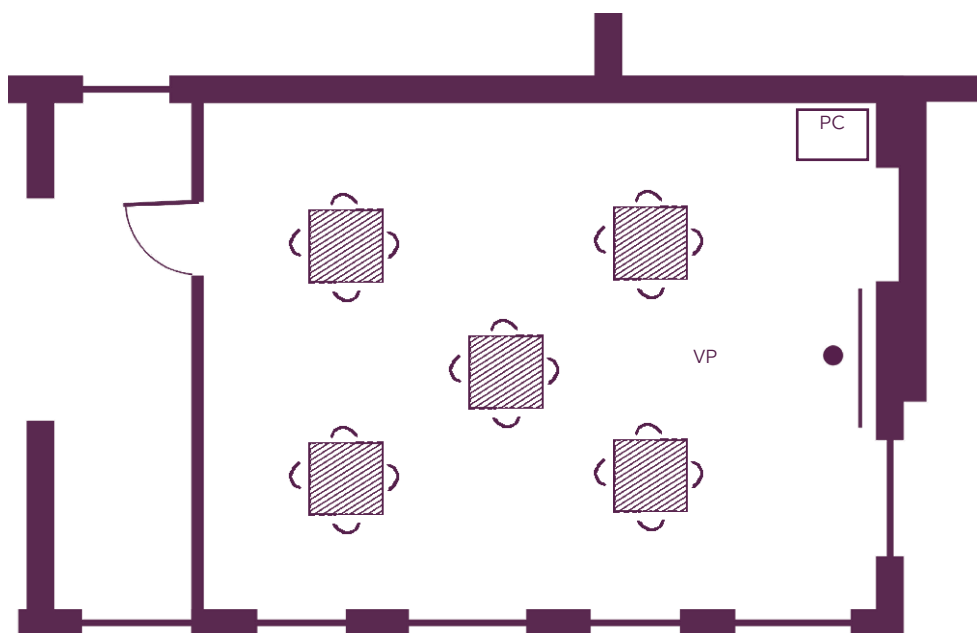

Galaboda
20 participants en "Ilôts"
(63 m², 9 m x 7 m)

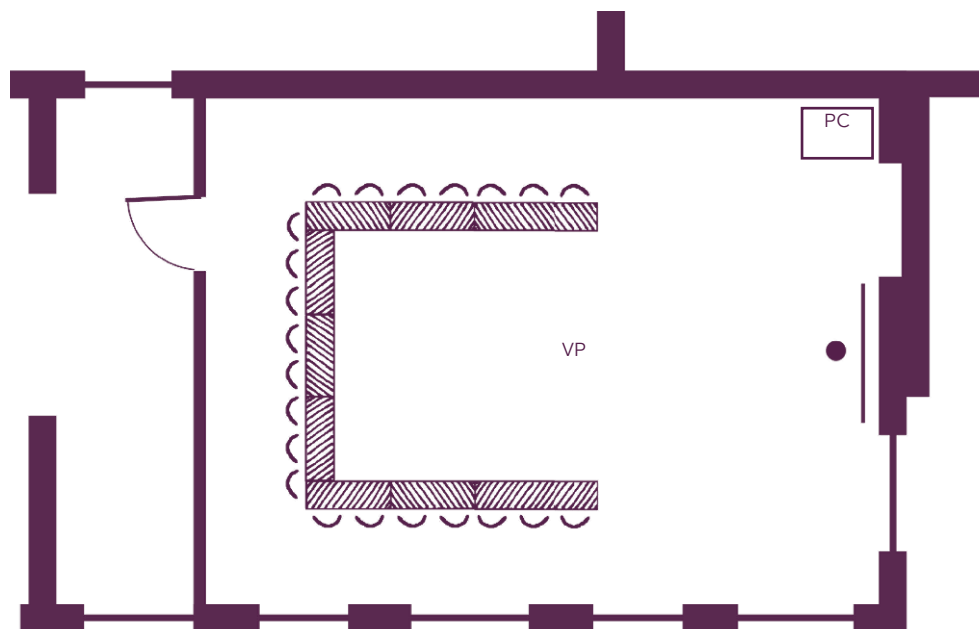

Galaboda
22 participants en "U"
(63 m², 9 m x 7 m)



Vos salles de réunion

La disposition en fonction de vos objectifs

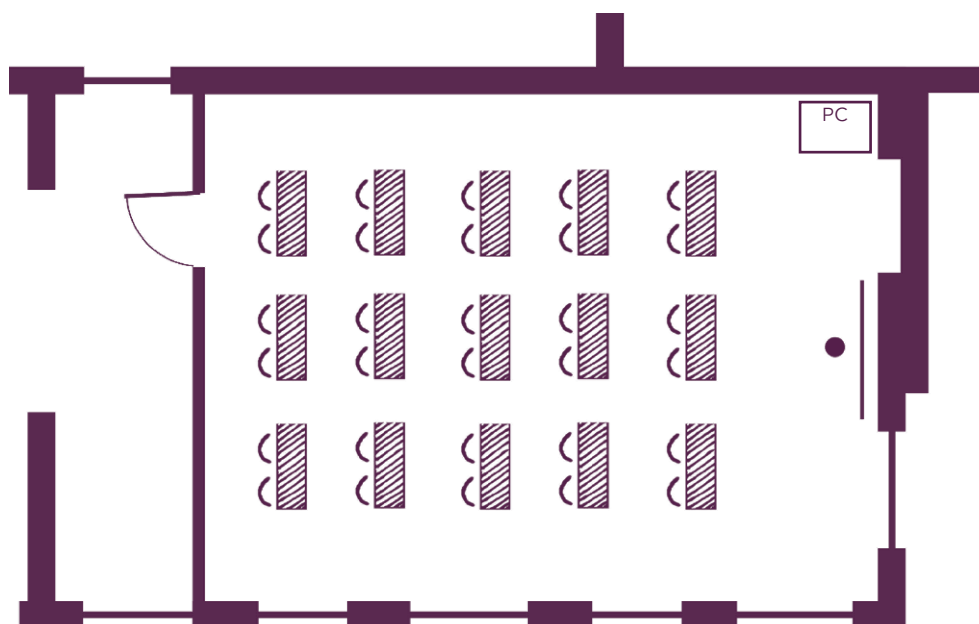

Galaboda
30 participants en "Classe"
(63 m², 9 m x 7 m)

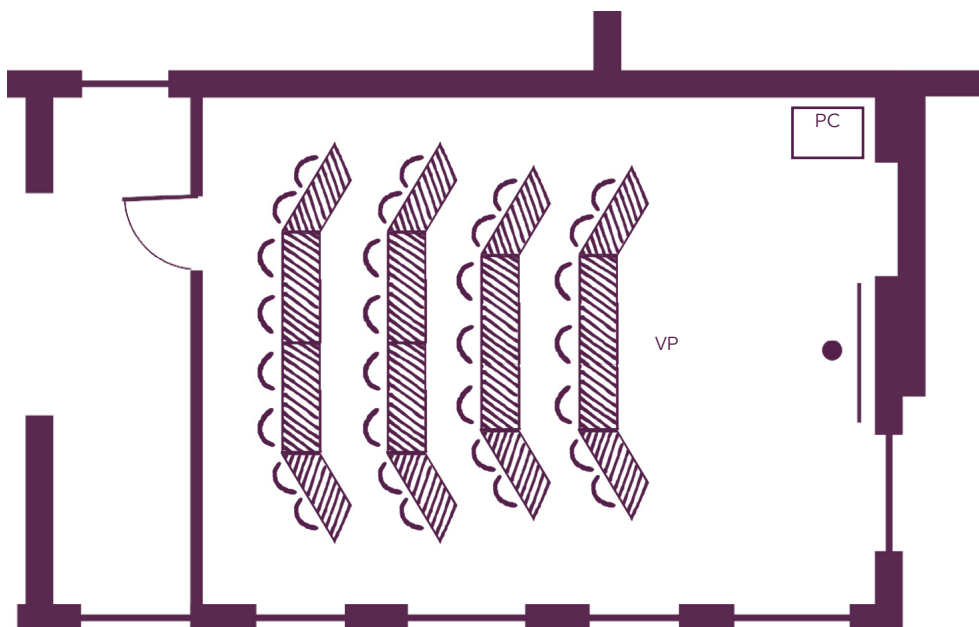

Galaboda
30 participants en "Amphi"
(63 m², 9 m x 7 m)



Vos salles de réunion

La disposition en fonction de vos objectifs

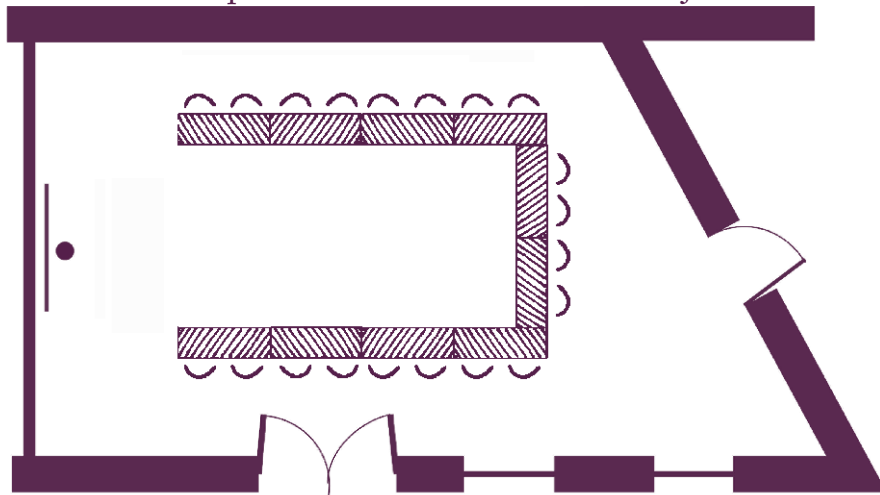

Kenilworth
20 participants en "U"
(40 m², 8 m x 5 m)

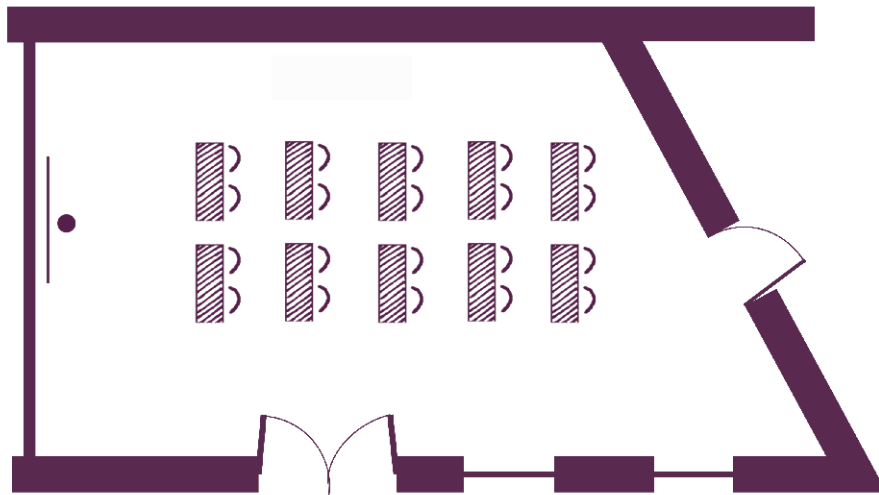

Kenilworth
20 participants en "Classe"
(40 m², 8 m x 5 m)

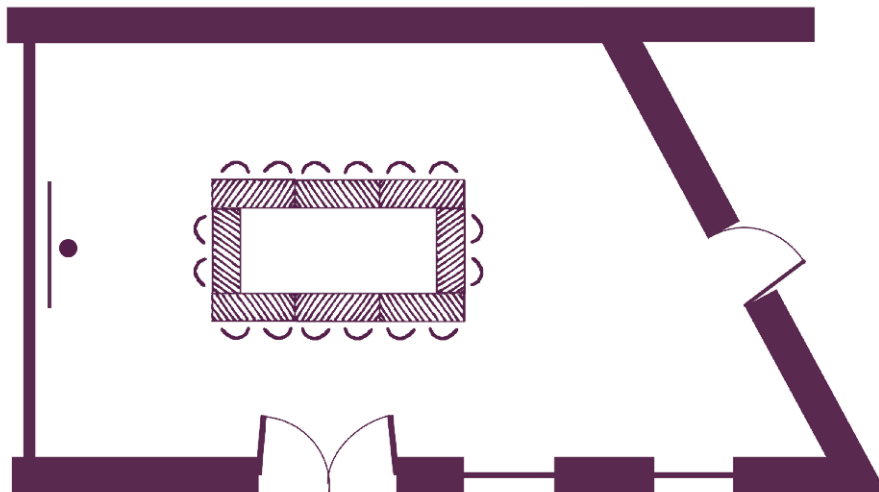

Kenilworth
16 participants en "Conférence"
(40 m², 8 m x 5 m)



Vos salles de réunion

La disposition en fonction de vos objectifs

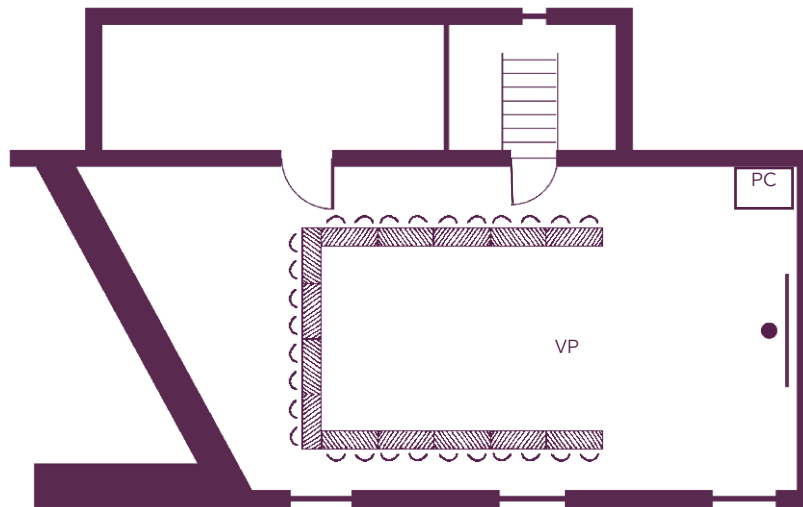

Flor de Oro
29 participants en "U"
(75 m², 11,5 m x 6,5 m)

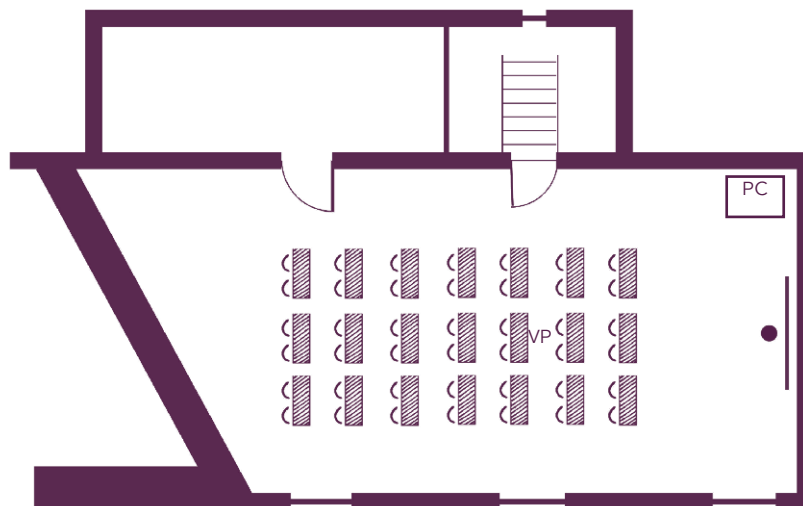

Flor de Oro
42 participants en "Classe"
(75 m², 11,5 m x 6,5 m)

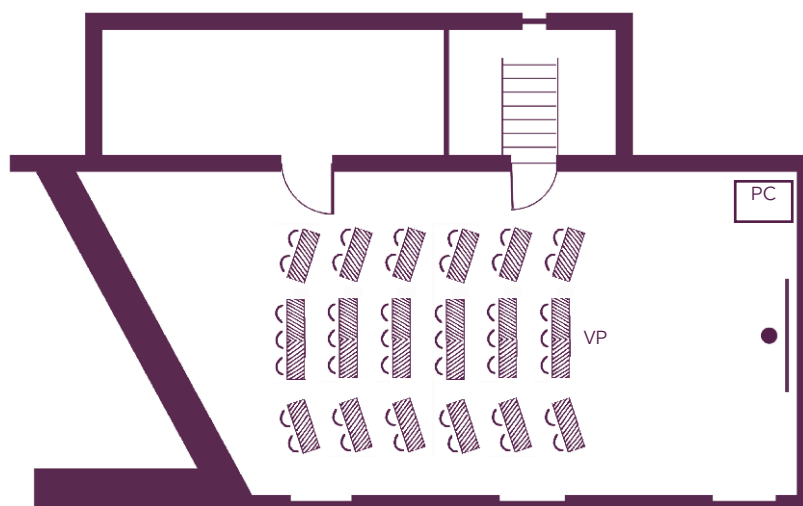

Flor de Oro
42 participants en "Amphi"
(75 m², 11,5 m x 6,5 m)



Vos salles de réunion

La disposition en fonction de vos objectifs

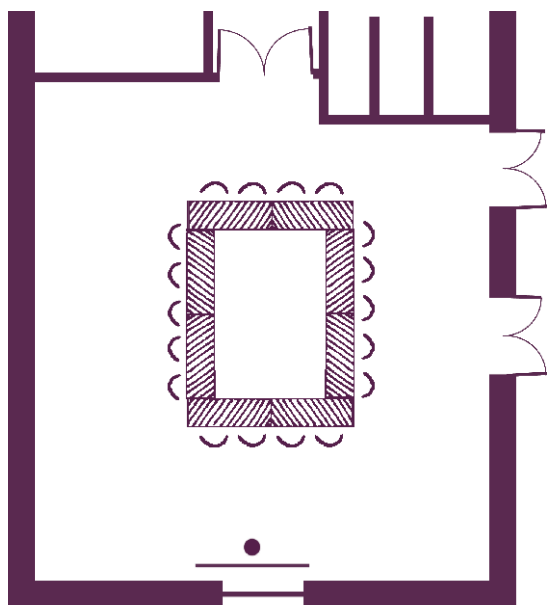

Goût Russe Impérial
18 participants en "Conférence"
(70 m², 10 m x 7 m)

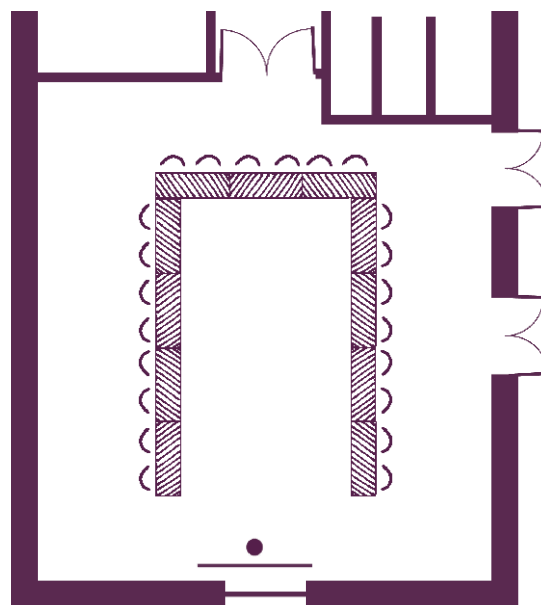

Goût Russe Impérial
22 participants en "U"
(70 m², 10 m x 7 m)

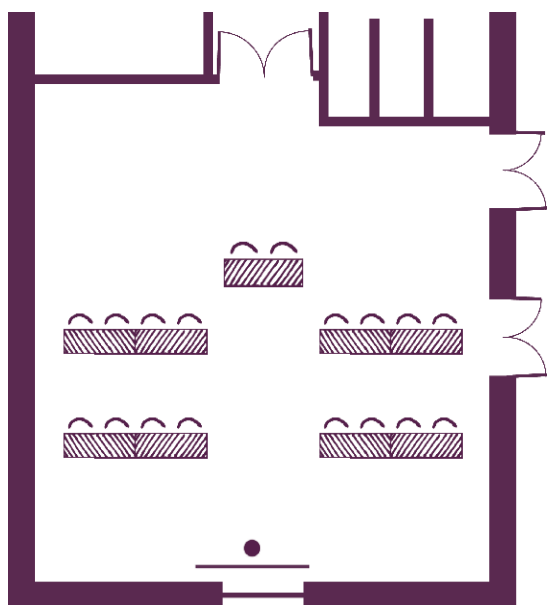

Goût Russe Impérial
20 participants en "Classe"
(70 m², 10 m x 7 m)

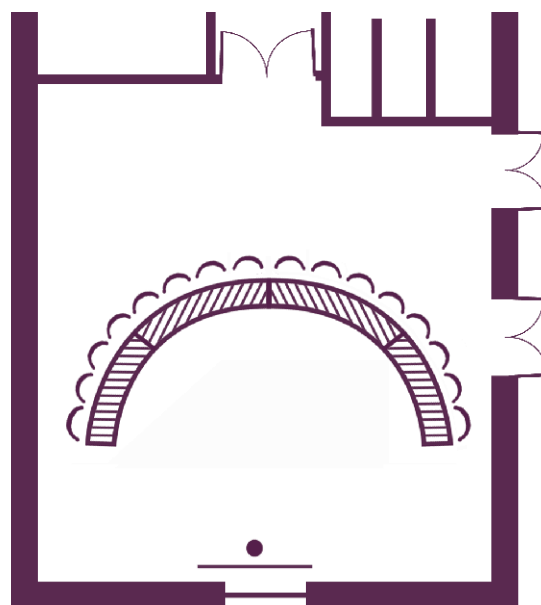

Goût Russe Impérial
16 participants en "Arc de cercle"
(70 m², 10 m x 7 m)



Vos salles de réunion

La disposition en fonction de vos objectifs

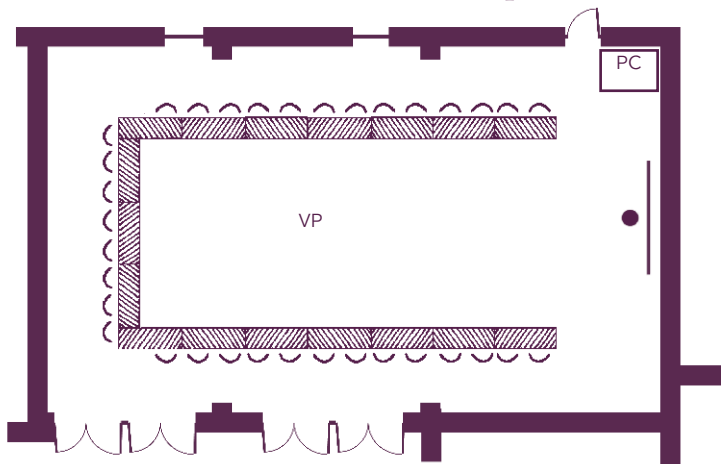

Thé des Lords
34 participants en "U"
(108 m², 13,5 m x 8 m)

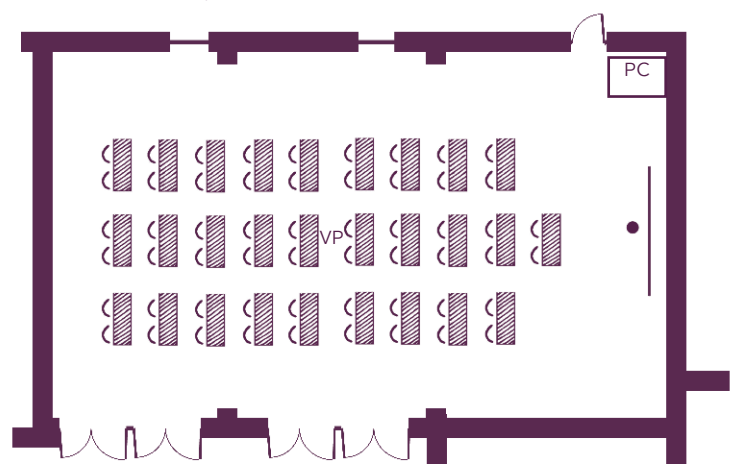

Thé des Lords
56 participants en "Classe"
(108 m², 13,5 m x 8 m)

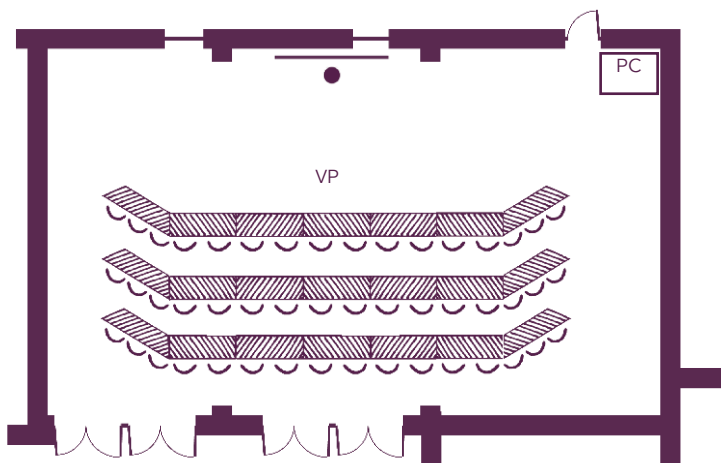

Thé des Lords
48 participants en "Amphi"
(108 m², 13,5 m x 8 m)

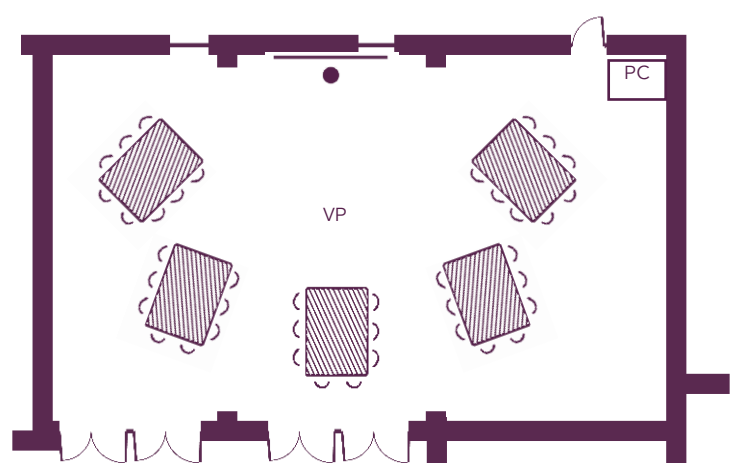

Thé des Lords
40 participants en "Ilots"
(108 m², 13,5 m x 8 m)

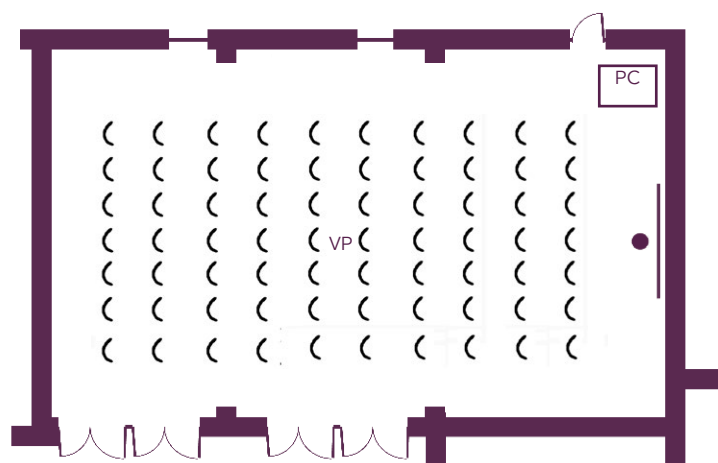

Thé des Lords
70 participants en "Théâtre"
(108 m², 13,5 m x 8 m)



Vos salles de réunion

La disposition en fonction de vos objectifs

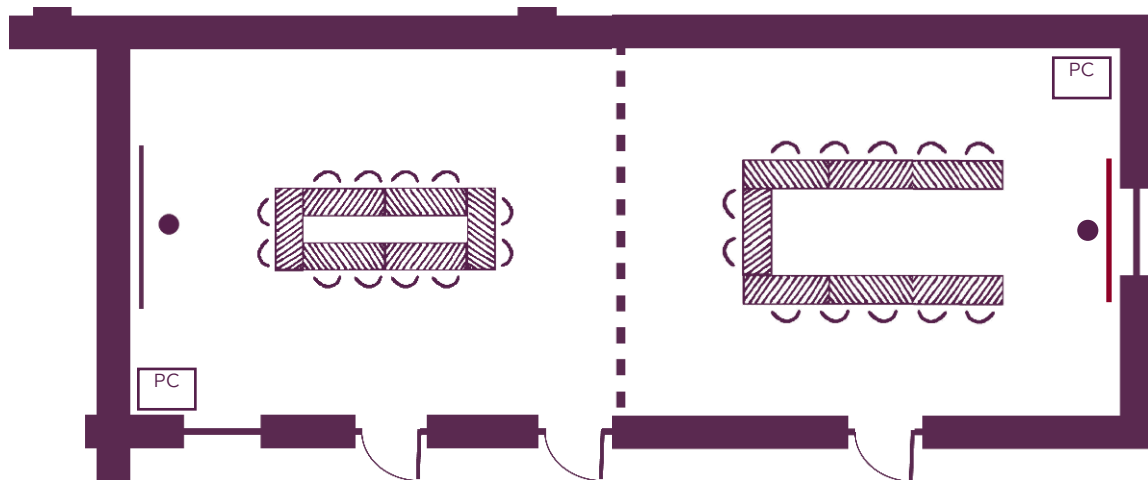

Queen Blend
12 participants en "U"
(35 m², 5 m x 7 m)

Irish Blend
12 participants en "U"
(30 m², 5 m x 6 m)

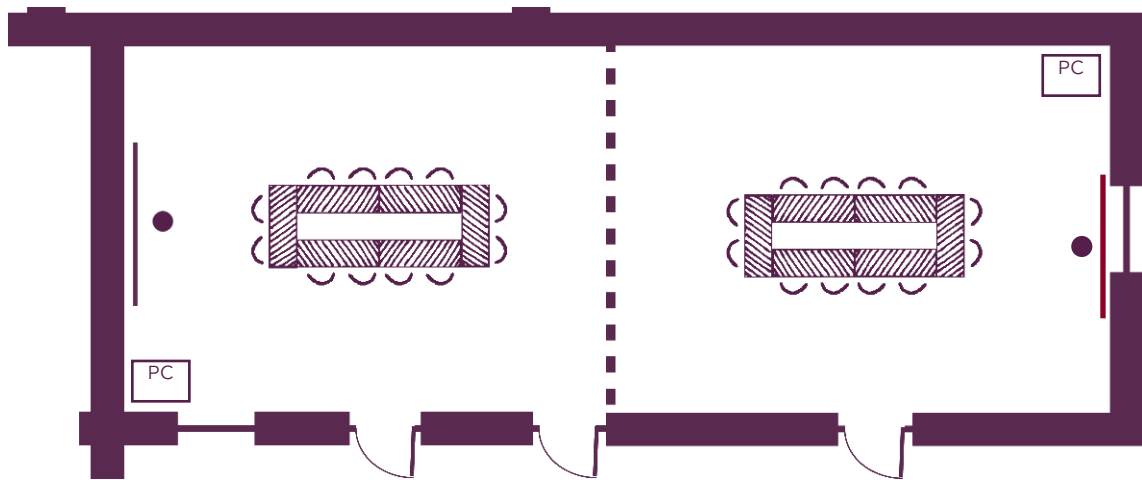

Queen Blend
12 participants en "Conférence"
(35 m², 5 m x 7 m)

Irish Blend
12 participants en "Conférence"
(30 m², 5 m x 6 m)



Queen Blend et Irish Blend
24 participants en "U"
(65 m², 5 m x 13 m)

